

RIVERHOMES

Chelsea Harbour
Chelsea SW10

£100,000
Leisure mooring



Chelsea Harbour Chelsea SW10

Aquila of Scotland is a beautiful example of a gentleman's motor yacht, designed and built by Bushnells, of Wargrave in 1963/64. The vessel is 47 ft long with a beam of 14.6 ft and has a fully moulded GRP keel. A pair of T6.354.4 Perkins 6 cylinder engines rated at 185hp were fitted approx 8 years ago. Inside is spacious and flooded with natural light. All the internal spaces offer excellent head room which makes her a pleasure to be aboard. Accommodation comprises two cabins and an en suite shower room to the master cabin. The living area has plenty of storage space and there are steps down to the kitchen area.

A large wheelhouse on the upper deck leads to a good size deck which can be enjoyed all year round. Aquila of Scotland is a great cruising boat as well as an attractive and spacious pied-à-terre. Chelsea Harbour is a tranquil haven from the buzz of the city. The development is served by Imperial Wharf national rail station which links to the tube. It provides direct rail links with Clapham Junction and Willesden Junction, as well as Southern services to Milton Keynes Central and East Croydon. There are bus services including buse route C3 which links Chelsea Harbour with Earl's Court, Fulham and Clapham Junction.

KEY FEATURES

47 ft. long vessel

**Two 6 cylinder Perkins 6.354.4 diesels,
Rated at 185 hp each**

Spacious and flooded with natural light

Two cabins

Ample storage

Large wheelhouse

**Great cruising boat as well as spacious
pied-à-terre**

**Mooring charges: £14,242.80 (inc. VAT)
per year**





KEY INFORMATION

Local authority: Royal Borough of Kensington and Chelsea

Internal area: 607 sq. ft. / 56 sq. m.

Garden area: Deck

No. of bedrooms: 2

CHELSEA HARBOUR, SW10

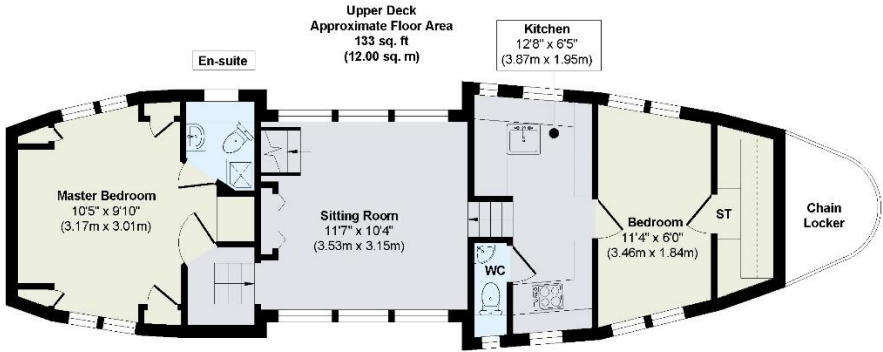
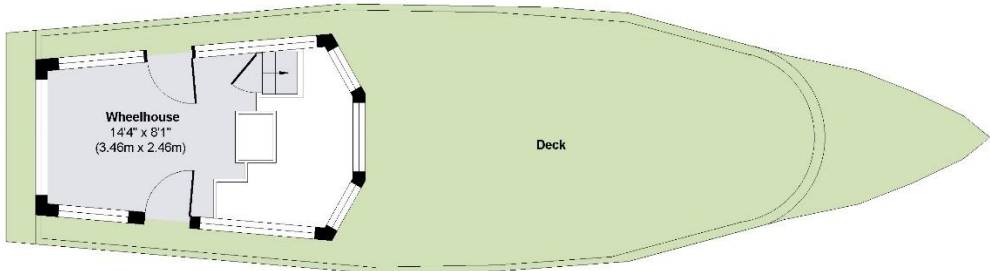

Approx. Gross Internal Floor Area 607 sq. ft / 56.00 sq. m
Illustration for identification purposes only, measurements are approximate, not to scale.

World Waterside Ltd trading as riverhomes for themselves and its clients give notice that 1: They are not authorised to make or give any representations or warranties in relation to the property either here or elsewhere, either on their own behalf or on behalf of their client or otherwise. 2: These particulars do not form part of any offer or contract and must not be relied upon as statements or representations of fact. Any areas, measurements or distances are approximate. The text, photographs and plans are for guidance only and are not necessarily comprehensive. 3: It should not be assumed that the property has all necessary planning, building regulation or other consents and any services, equipment or facilities have not been tested. 4: Lease details, service charges, ground rent (where applicable) and council tax are given as a guide only and should be checked and confirmed by your Solicitor prior to exchange of contracts. 5: They assume no responsibility and any intending purchasers or tenants must satisfy themselves by inspection or otherwise as to the correctness of each of the statements contained within these particulars. If you require clarification of any points please contact us.