

RIVERHOMES

St Katharine Docks
Wapping E1W

£210,000
Leisure Mooring



St Katharine Docks Wapping E1W

RiverHomes is delighted to offer to the market this stunning brand new 60 ft. x 12.6 ft. widebeam barge. The barge is located on a prime mooring in St Katharine Docks and is the perfect pied-à-terre in Central London. The barge comprises a beautifully crafted large double bedroom with king size bed, built-in storage and portholes creating a light space. Door leading to the large bathroom with double shower. The generously sized kitchen/ living area has been tastefully designed with quartz work surfaces, worktops and cupboards. The kitchen also has a built-in dishwasher, washing machine and oven/hob. The windows provide

an abundance of natural light and are meticulously finished to a very high standard. Storage has been installed throughout the boat in every spare space thus creating a high-end minimalistic feel. The dock also offers excellent transport links; Tower Hill Underground and Tower Gateway DLR Stations are a short walk away. There are also numerous restaurants and bars located within the marina, offering residents and visitors a variety of options. The Directors have an interest in this vessel.

KEY FEATURES

Brand new build vessel

Windows and portholes are double glazed

60 ft. x 12.6 ft. widebeam barge

A beautifully crafted large double bedroom

Ample storage

Interior finished to a very high standard

Excellent transport links

The generously sized kitchen/ living area has been tastefully designed with quartz work surfaces, worktops and cupboards

Mooring Charges: £19,000 incl. VAT per year approx.

The mooring fees shown on this brochure or provided by RiverHomes verbally are the current mooring fees the existing owner of the vessel is paying. All prospective buyers should make their own enquiries with the marina or mooring management directly to understand the ongoing costs and mooring fees payable by a new owner. The mooring is not being sold by RiverHomes, only the vessel thus the mooring is by separate negotiation with the marina or mooring management. This statement applies unless a member of RiverHomes staff notifies you otherwise in writing.





RIVERHOMES

Central London Branch
Tintagel House
92 Albert Embankment
Vauxhall
SE1 7TY

020 7407 8000
www.riverhomes.co.uk

KEY INFORMATION

Local authority: London Borough of Tower Hamlet

Internal area: 582 sq. ft. / 54 sq. m.

Garden area: Deck

No. of bedrooms: 1

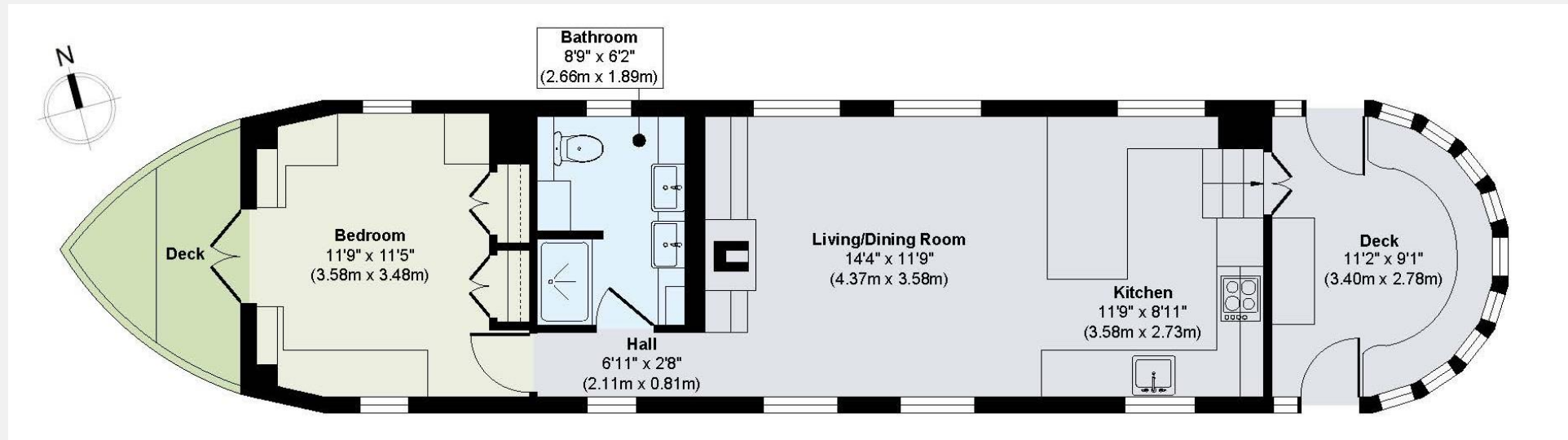

World Waterside Ltd trading as riverhomes for themselves and its clients give notice that 1: They are not authorised to make or give any representations or warranties in relation to the property either here or elsewhere, either on their own behalf or on behalf of their client or otherwise. 2: These particulars do not form part of any offer or contract and must not be relied upon as statements or representations of fact. Any areas, measurements or distances are approximate. The text, photographs and plans are for guidance only and are not necessarily comprehensive. 3: It should not be assumed that the property has all necessary planning, building regulation or other consents and any services, equipment or facilities have not been tested. 4: Lease details, service charges, ground rent (where applicable) and council tax are given as a guide only and should be checked and confirmed by your Solicitor prior to exchange of contracts. 5: They assume no responsibility and any intending purchasers or tenants must satisfy themselves by inspection or otherwise as to the correctness of each of the statements contained within these particulars. If you require clarification of any points please contact us.